

# Detalle de Juntas de Aberturas Metàlicas

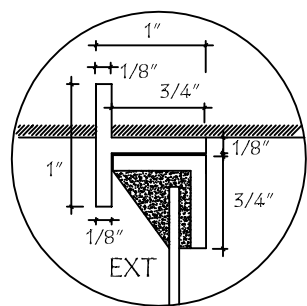

A-A

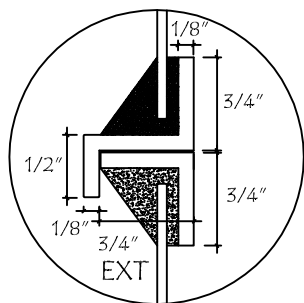

B-B

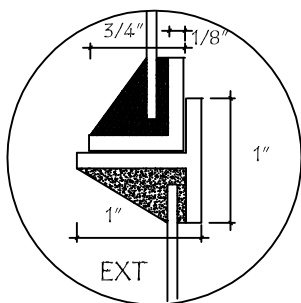

C-C

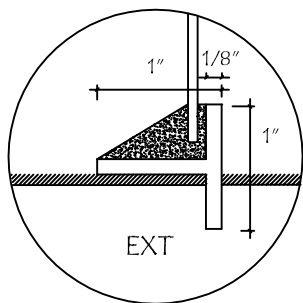

D-D

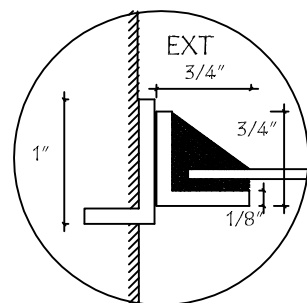

H-H

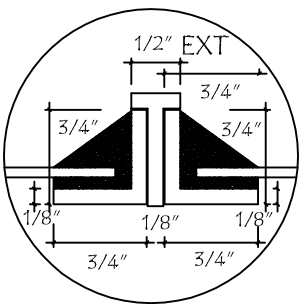

I-I

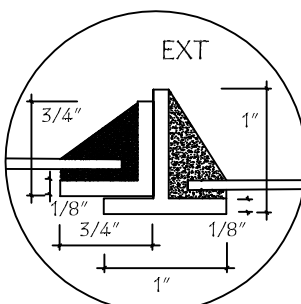

J-J

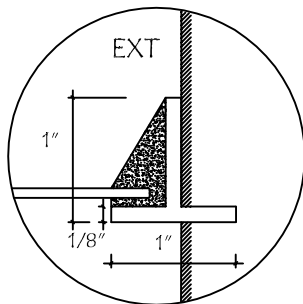

K-K

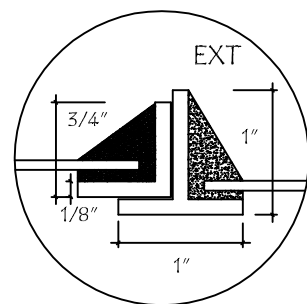

N-N

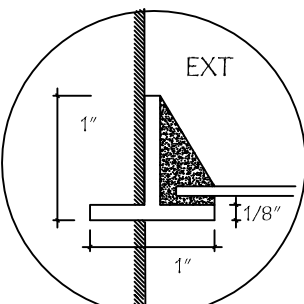

N̄-N̄

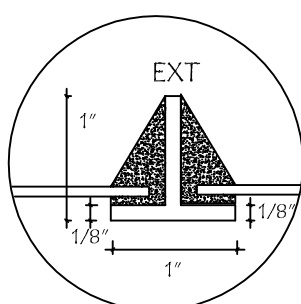

O-O

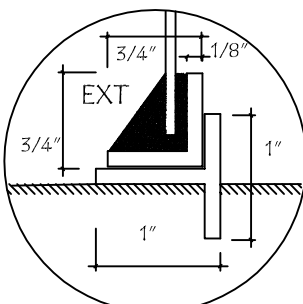

P-P

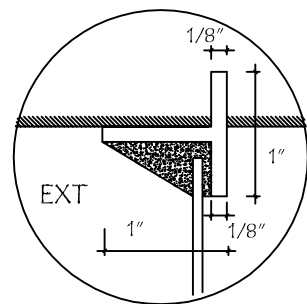

E-E

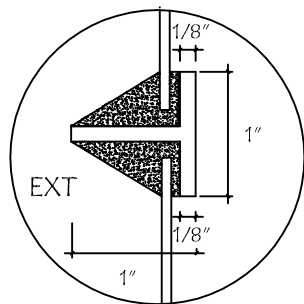

F-F

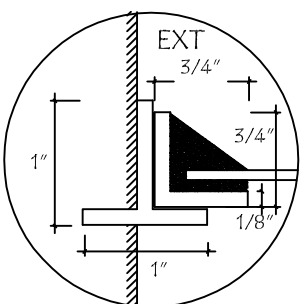

L-L

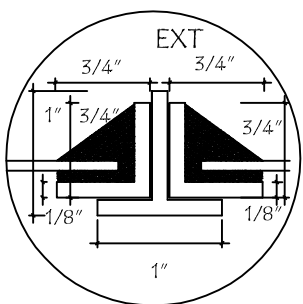

M-M

MINISTERIO DE EDUCACION Y CIENCIAS  
DIRECCION DE INFRAESTRUCTURA

PROYECTO

Cocina - Comedor de 8,60 x 10,90 con techo de tejas

Detalle de Juntas de balancín

sin escala

5