

The map shows the Rectorado area in Montevideo, Uruguay. It features two large rectangular blocks, labeled 'BLOQUE A' and 'RECTORADO'. The dimensions of these blocks and the distance between them are indicated by arrows and text:

- The top block (BLOQUE A) has a width of 42.80 and a height of 21.25.
- The bottom block (RECTORADO) has a width of 42.80 and a height of 21.25.
- The distance between the two blocks is 10.00.

The map also shows the surrounding streets and the location of the Rectorado building, which is a large, multi-story structure with a central tower.

[illegible]

The floor plan shows a symmetrical layout of eight lecture rooms, labeled AULA 1 through AULA 8. The rooms are arranged in two rows of four, with AULA 1 and AULA 2 on the left, and AULA 3 through AULA 8 on the right. Each room is rectangular and contains several rows of desks and chairs, with a blackboard and a projector screen at the front. The plan includes dimensions for the rooms and the overall hall, as well as a scale bar at the top.



# DETALLE DE VIGAS INFERIOR Y SUPERIOR

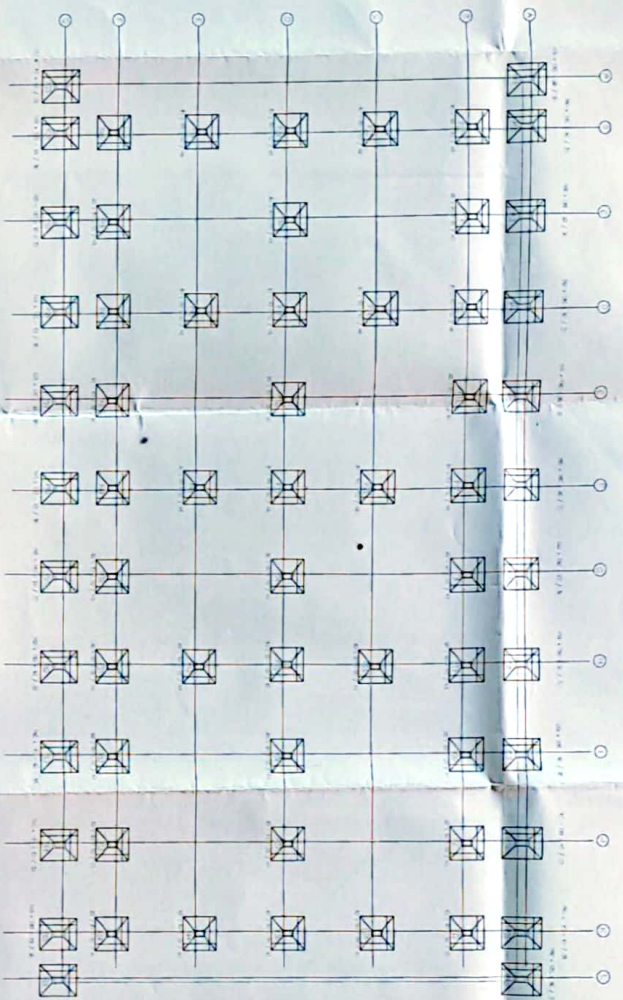

## PLANTA DE FUNDACIÓN Y REPLANTEO EDIFICIO AULAS - A ESCALA 1:100

### DETALLE DE ZAPATAS Y PILARES DE HORMIGON

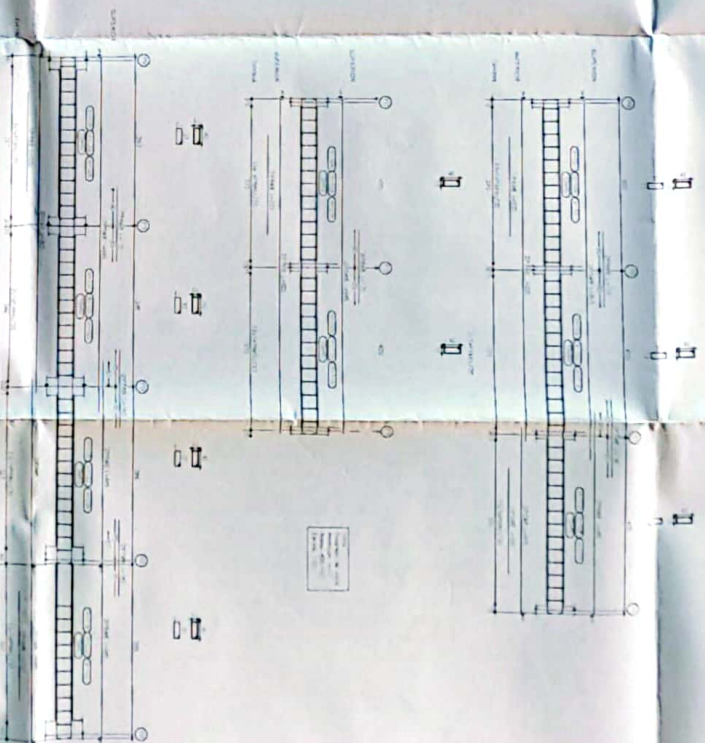
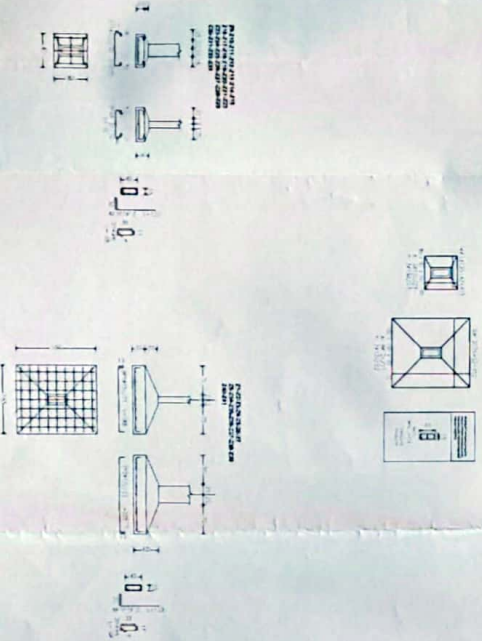

APROBADO  
M. E. M. A. L. A. S.  
M. E. M. A. L. A. S.

CONSTRUCCIÓN DE AULAS - FUNDACIÓN Y REPLANTEO  
APROBADO  
M. E. M. A. L. A. S.  
M. E. M. A. L. A. S.

CONSTRUCCIÓN DE AULAS - FUNDACIÓN Y REPLANTEO  
APROBADO  
M. E. M. A. L. A. S.  
M. E. M. A. L. A. S.

CONSTRUCCIÓN DE AULAS - FUNDACIÓN Y REPLANTEO  
APROBADO  
M. E. M. A. L. A. S.  
M. E. M. A. L. A. S.

CONSTRUCCIÓN DE AULAS - FUNDACIÓN Y REPLANTEO  
APROBADO  
M. E. M. A. L. A. S.  
M. E. M. A. L. A. S.



