

DISTRIBUCIÓN DE JUNTAS DE DILATACIÓN  
ESCALA: 1/100

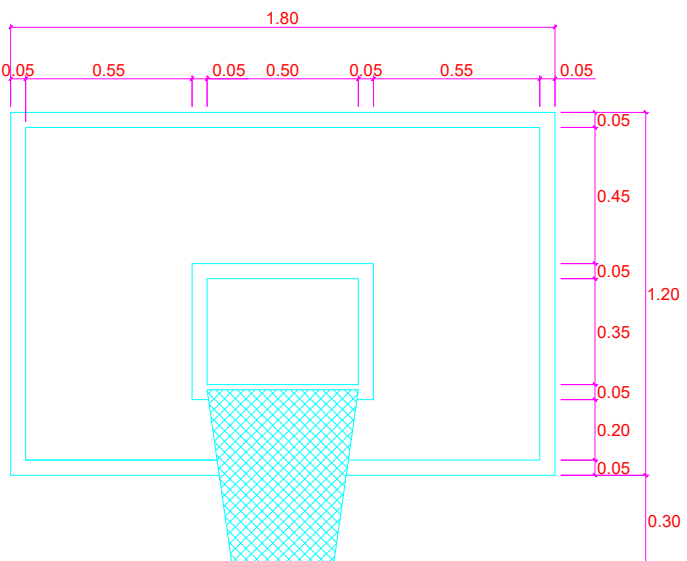

VISTA FRONTAL  
ESCALA: 1/25

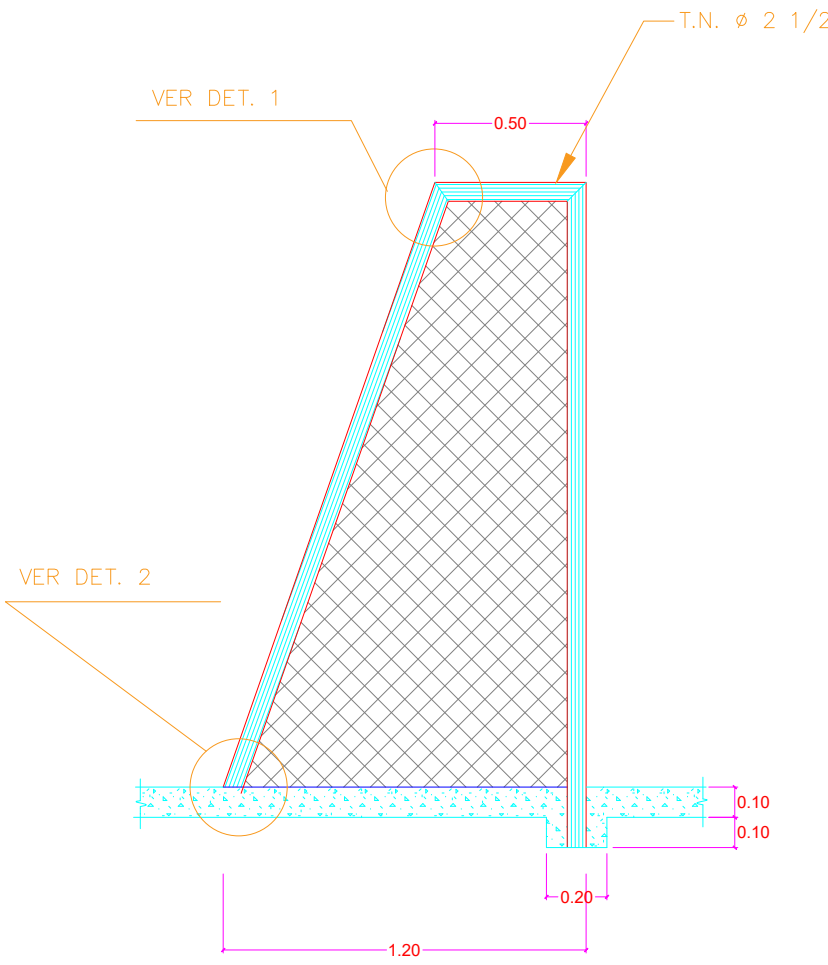

ELEVACION LATERAL  
ESCALA: 1/25

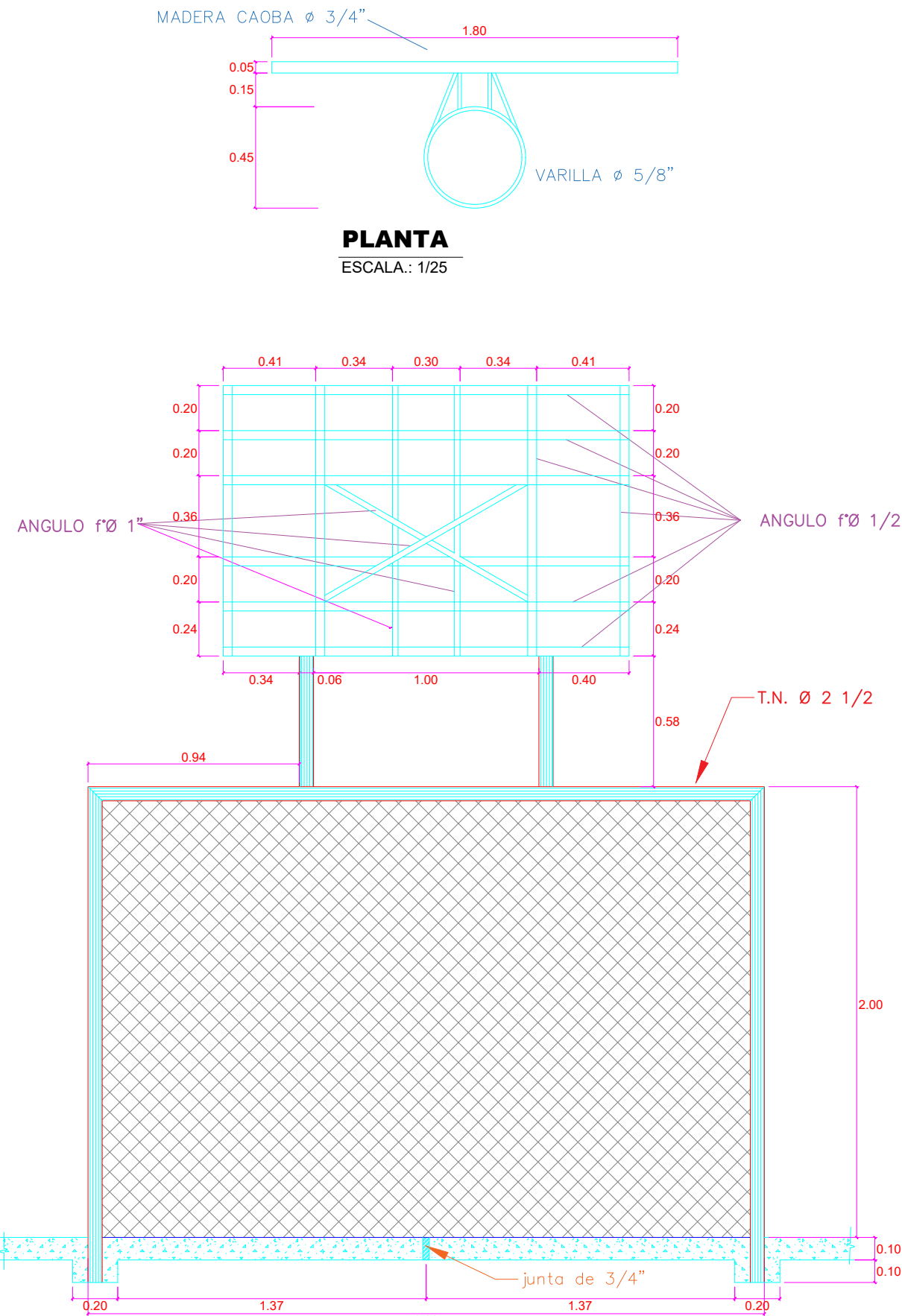

ELEVACION FRONTAL  
ESCALA: 1/25

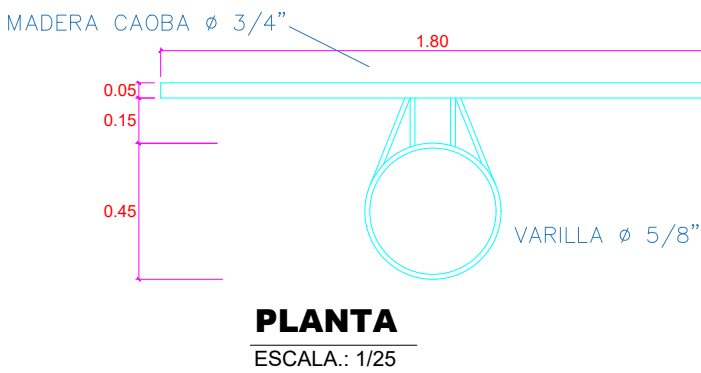

PLANTA  
ESCALA: 1/25

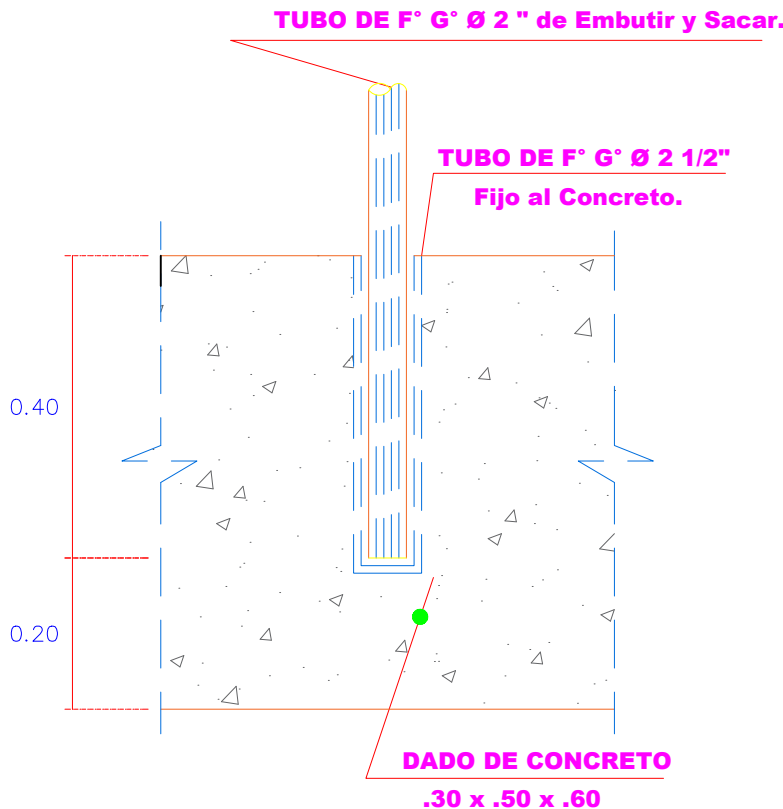

Detalle 1  
Esc. : 1/10

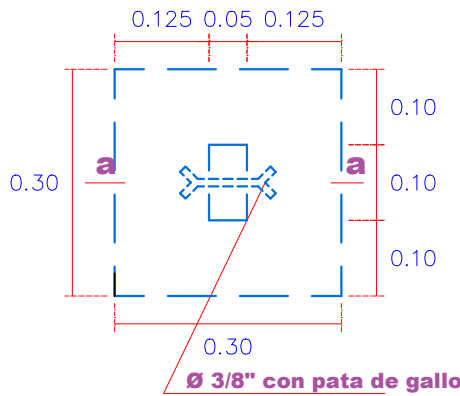

Detalle 2  
Esc. : 1/10

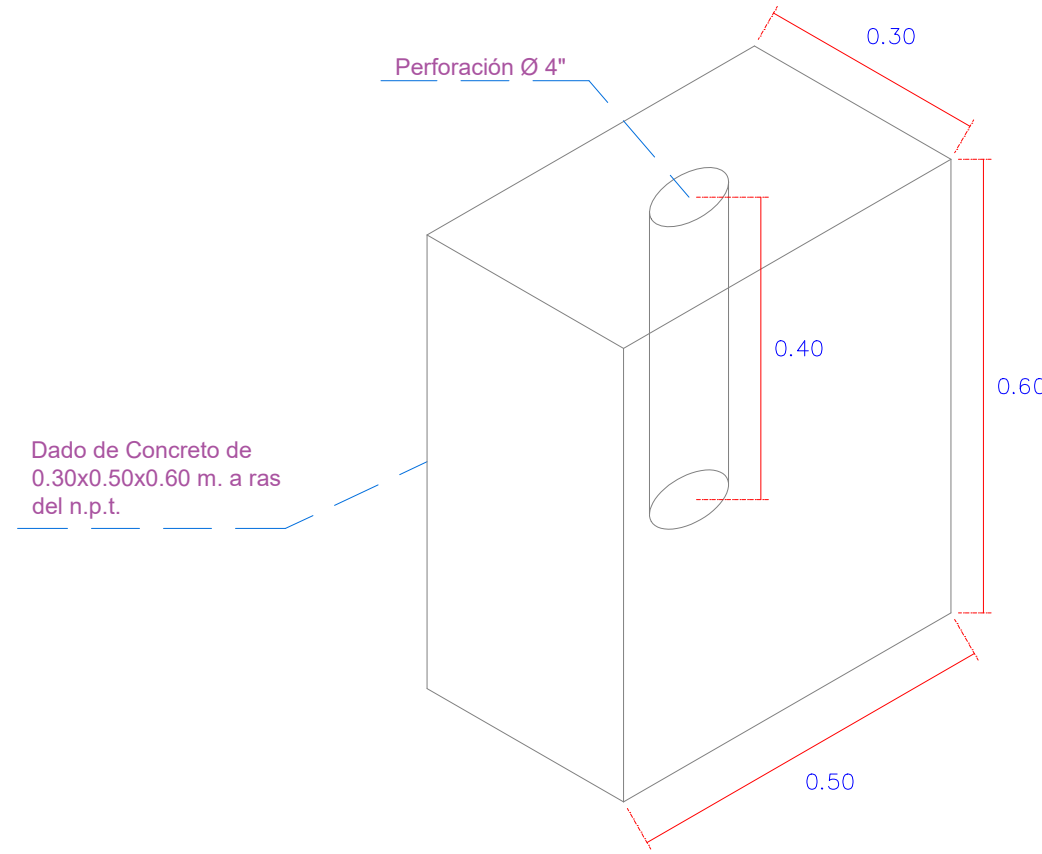

Detalle N° 1  
en 3D  
Esc. : 1/10

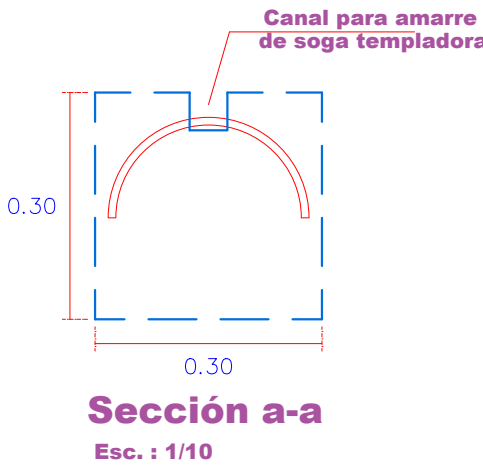

Sección a-a  
Esc. : 1/10

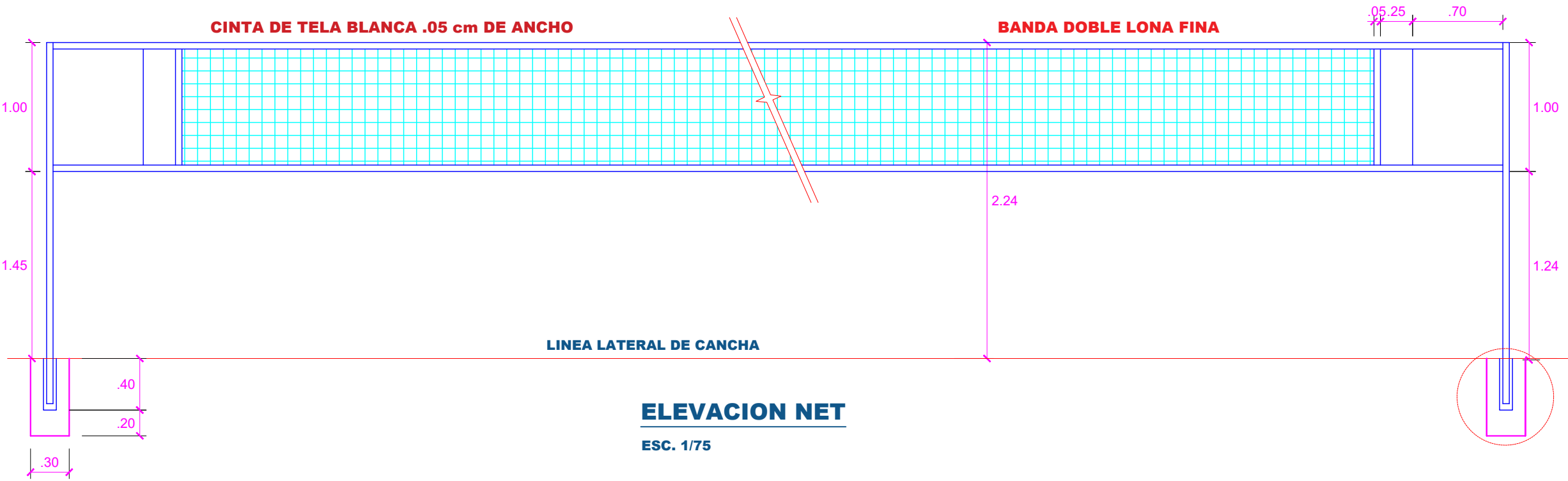

ELEVACION NET  
ESC. 1/75

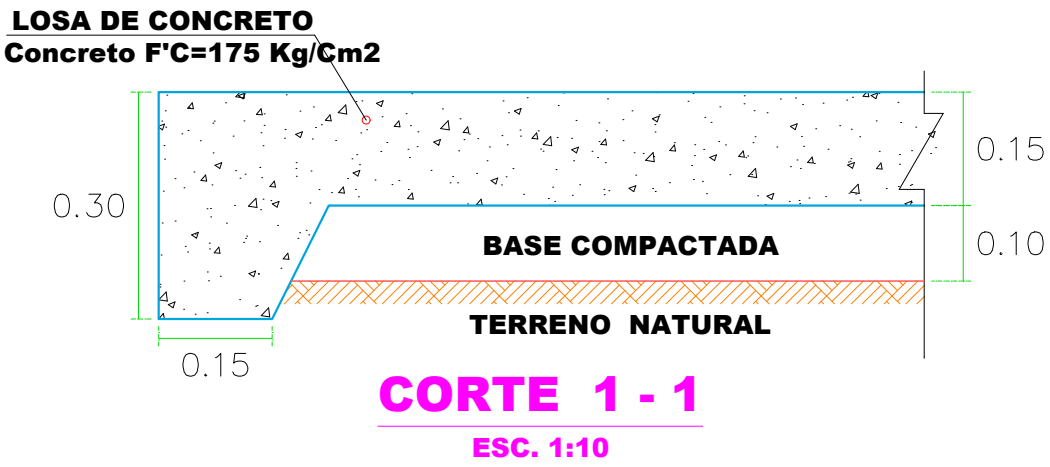

CORTE 1 - 1  
ESC. 1:10

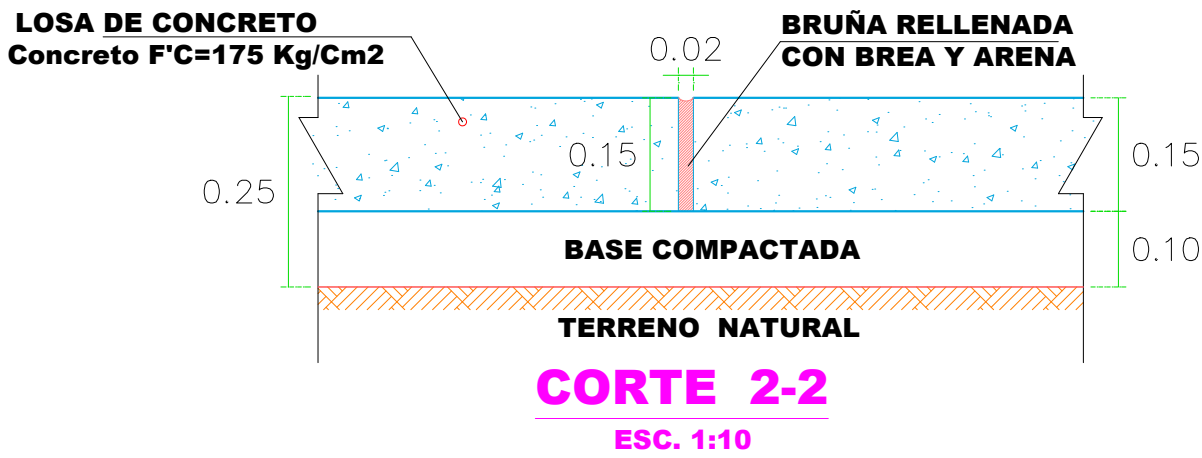

CORTE 2-2  
ESC. 1:10

 <b>Municipalidad de Nueva Alborada</b>		
OBRA: "CONSTRUCCION DE LOSA DEPORTIVA EN COLEGIO NACIONAL DE PUERTO SAMUHÚ DISTRITO DE NUEVA ALBORADA"		
PLANO: DETALLES DE LOSA E IMPLIMENTOS DEPORTIVOS	LÁMINA N°	
 Arg. Damián Benítez Fiscal de Obras	 Municipalidad de Nueva Alborada Oscar Albino Martínez Ramírez Presidente Municipal	<b>02</b> ABRIL 2024